

CATERPILLAR 3126E C-7, C-9 Only

FOR VEHICLES: (WITHOUT) Allison WT transmissions (WITHOUT) ABS braking (WITHOUT) on-board air system

Note: Engine ECU must be enabled by a Caterpillar dealer.

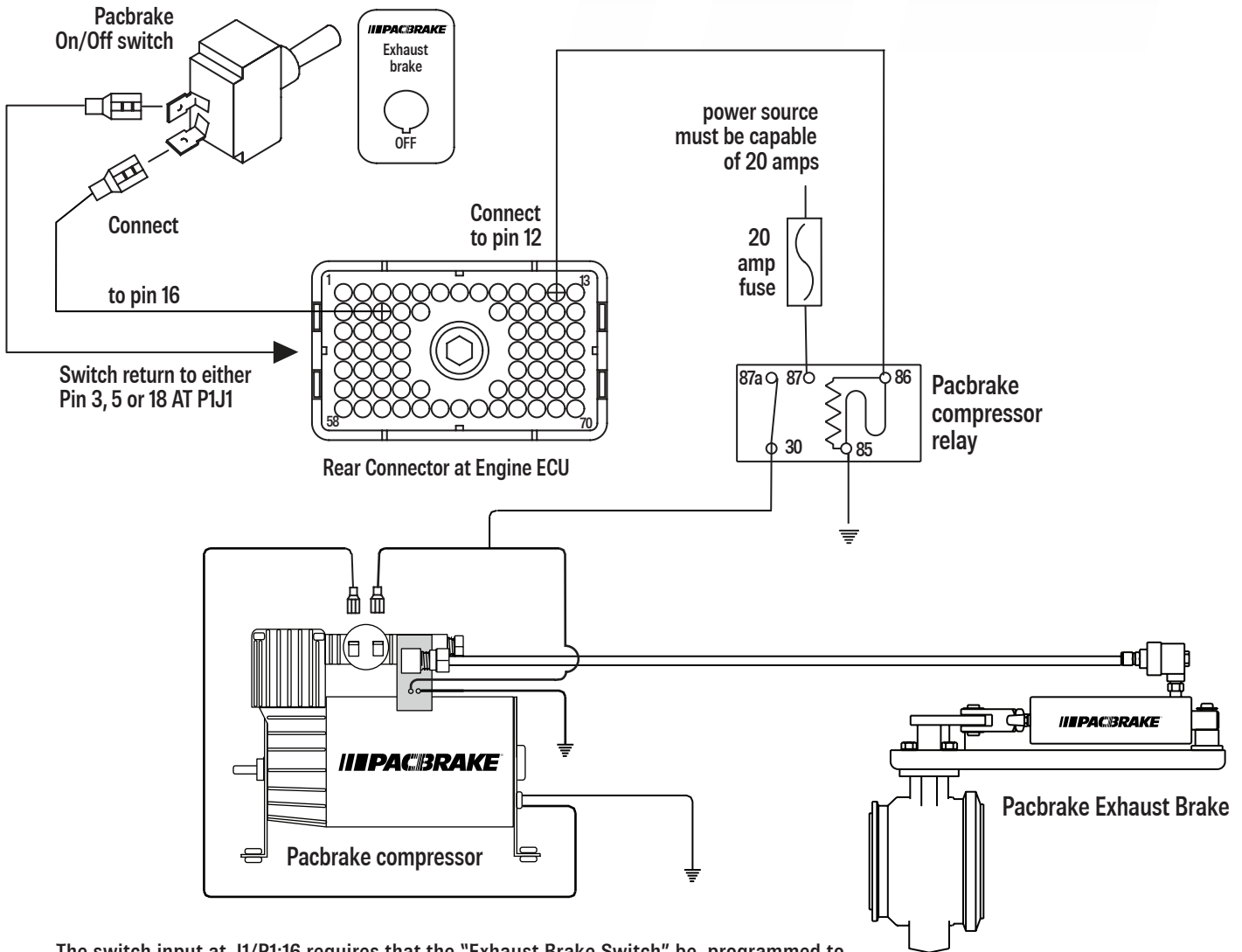

The switch input at J1/P1:16 requires that the "Exhaust Brake Switch" be programmed to "Installed". The Parameter "Exhaust Brake Warm-Up Configuration" must be programmed to "Exhaust Brake Only" or "Exhaust Brake & Warm-up".

Early 2002 production 3126E engines have the ability to be programmed to allow the exhaust brake to assist the engine in warming up faster in cold weather. Program, customer parameter to "Exhaust Brake and Warm-up" and program warm-up mode IDLE speed to 1100 RPM.

NOTE:

- * View shown is looking at the harness side of the connector.
- Relays shown are de-energized.
- Information for this schematic was derived from vehicle systems at the date of this printing.
- Updates or variations by vehicle manufacturers constituting changes will not be the responsibility of Pacbrake.