

# WIRING SCHEMATIC **EXHAUST BRAKE**

## DETROIT DIESEL SERIES 60 ENGINES WITH DDEC II ECM

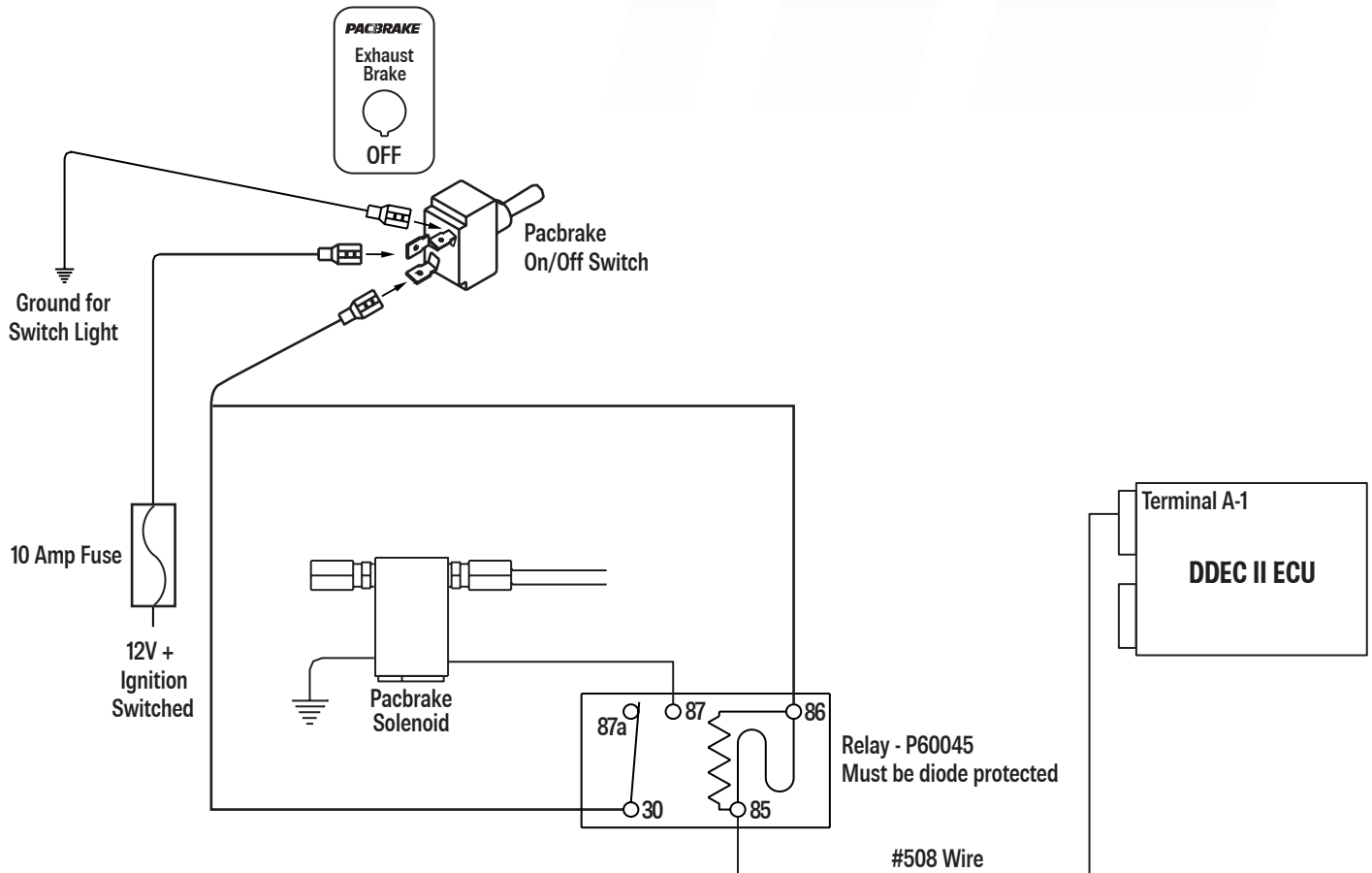

- 16 gage wire is recommended but not included.
- Vehicles equipped with an automatic transmission require the exhaust brake circuit be interfaced with the transmission ECU.
- Metri-pac connector and harness not necessary on DDEC II application.
- Vehicles equipped with ABS braking require the exhaust brake be interfaced with the ABS ECU.
- Information for this schematic was derived from vehicle systems at the date of this printing.
- Updates or variations by vehicle manufacturers constituting changes will not be the responsibility of Pacbrake.